

# Engine Idle Vibration Only in Reverse

**Service Category** Engine/Hybrid System

**Section** Engine Mechanical

**Market** USA

Toyota Supports  
 ASE Certification 

## Applicability

YEAR(S)	MODEL(S)	ADDITIONAL INFORMATION
2009	Venza	Drive Type(s): 4WD Engine(s): 1AR Transmission(s): 6AT VDS(s): BE11A

## Introduction

Some 2009 model year 4-cylinder AWD Venza vehicles may exhibit an engine idle vibration while the transaxle is in Reverse. A front engine support spacer has been developed to address this concern. Please use the following repair procedure to repair this condition.

## Parts Information

PREVIOUS PART NUMBER	CURRENT PART NUMBER	PART NAME	QTY
N/A	12319-0V070	Spacer, Engine Front Support	1

## Warranty Information

OP CODE	DESCRIPTION	TIME	OFF	T1	T2
EG9043	Install Front Engine Support Spacer	0.6	12322-20040	9B	44

### APPLICABLE WARRANTY

- This repair is covered under the Toyota Powertrain Warranty. This warranty is in effect for 60 months or 60,000 miles, whichever occurs first, from the vehicle's in-service date.
- Warranty application is limited to occurrence of the specified condition described in this bulletin.

## Engine Idle Vibration Only in Reverse

---

### Repair Procedure

1. Confirm the engine idle vibration only occurs while the transaxle is in Reverse.
  - **NO** — This TSB does NOT apply. Refer to the appropriate Repair Manual section for diagnosis.
  - **YES** — Proceed to step 2.
2. Remove the right front wheel.
3. Remove the rear engine mounting insulator assembly.

- A. Remove the 2 bolts and separate the rear engine mounting insulator assembly from the rear engine mounting bracket as shown in Figure 1.

Figure 1.

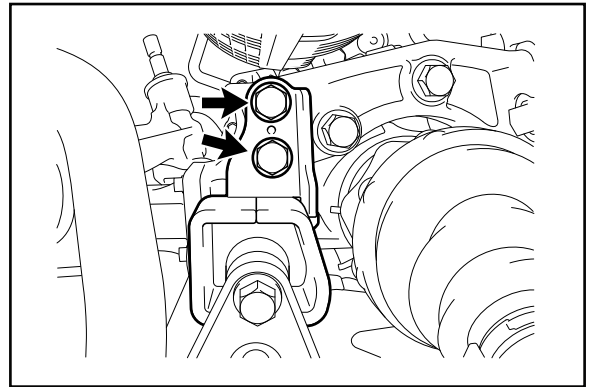

- B. Remove the 2 hole plugs from the front suspension member as shown in Figure 2.

Figure 2.

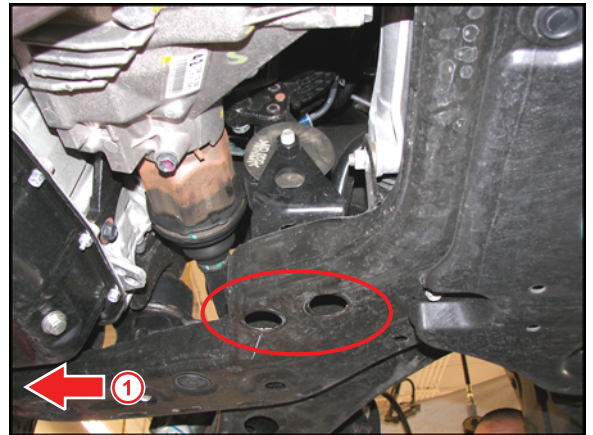

<b>1</b>	<b>Front of Vehicle</b>
----------	-------------------------

- C. Remove the 2 nuts inside the front suspension member.
- D. Remove the mount assembly.

## Engine Idle Vibration Only in Reverse

---

### Repair Procedure (Continued)

4. Clean the surface of the rear engine mounting insulator assembly and front suspension member.
5. Install the front engine support spacer on the rear engine mounting insulator as shown in Figure 3.

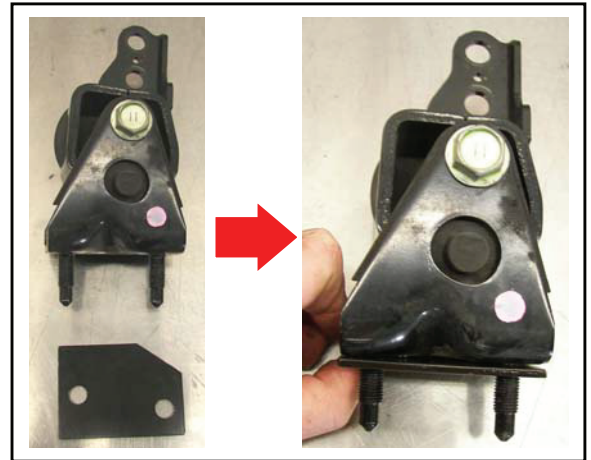

6. Reinstall the mount with spacer in reverse order.  
**Torque:**  
**Lower Nut: 52 N\*m (530 kgf\*cm, 38 ft\*lbf)**  
**Torque:**  
**Upper Bolt: 75 N\*m (764 kgf\*cm, 55 ft\*lbf)**
7. Install the right front wheel.  
**Torque: 103 N\*m (1050 kgf\*cm, 76 ft\*lbf)**
8. Confirm the engine idle vibration has been resolved.